

**COPYRIGHT**  
THIS DOCUMENT AND ALL DATA CONTAINED HEREIN REMAIN THE PROPERTY OF O'DALY ARCHITECTS. IT IS SUPPLIED IN CONFIDENCE FOR EVALUATION PURPOSES ONLY UNDER THE CONDITION THAT SAME IS NOT USED, REPRODUCED OR TRANSMITTED IN ANY WAY TO OTHERS WITHOUT WRITTEN CONSENT.

**DIMENSIONS**  
UNLESS OTHERWISE STATED, DIMENSIONS SHOWN ARE IN MILLIMETRES. NO DIMENSIONS TO BE SCALED FROM THIS DRAWING. ALL DIMENSIONS TO BE CHECKED BY THE CONTRACTOR ON SITE AND ANY DISCREPANCIES TO BE REPORTED TO THE ARCHITECT.

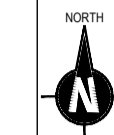

Key Plan  
Scale 1:5000

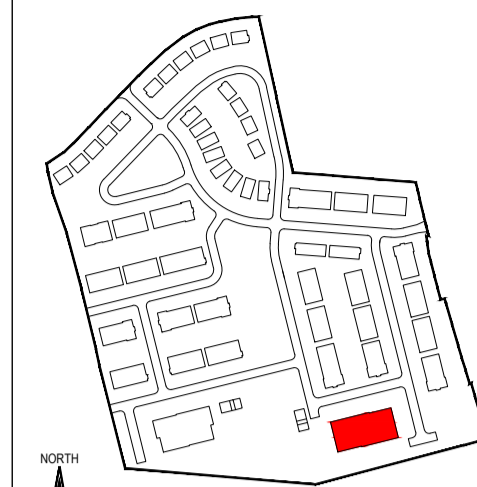
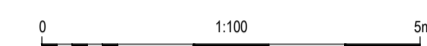

SECTION AA  
Scale 1:100

**THIS DRAWING SHOULD BE READ IN CONJUNCTION WITH THE APARTMENT QUALITY ASSESSMENT SCHEDULE DOCUMENT REF. 24004-AR-AQA**

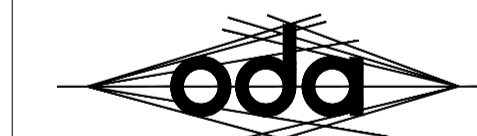

**o'daly architects**

1st Floor - Unit 13(B) - Mullaghboy Industrial Estate  
Navan - County Meath - Tel: (046) 9021233  
Mobile: (087) 0525233 - Email: ivan@odaly.ie



**Client:**  
Loughlynn Developments Ltd.

**Project Name and Address:**  
Proposed Residential Development at "Crowpark",  
Kildaskey Road, Trim, County Meath.

**Project Stage:**  
Planning

**Drawing Name:**  
Apartments Block B Section

**Drawn By:** iod  
**Scale:** 1:100 @ A1

**Checked By:** iod  
**Date:** 04.06.2026

**Drawing Number:** 24004-AR-315  
**Revision:** P01